



6314-ZNR Deep groove ball bearings

- SKF Explorer

Deep groove ball bearings

Bearing data

[Tolerances](#),

Normal (metric), P6, P5, Normal (inch),

[Radial internal clearance](#),

Matched bearing pairs, Stainless steel
 $d < 10$ mm, Other bearings

Bearing interfaces

[Seat tolerances for standard conditions](#),

[Tolerances and resultant fits](#)

Technical specification

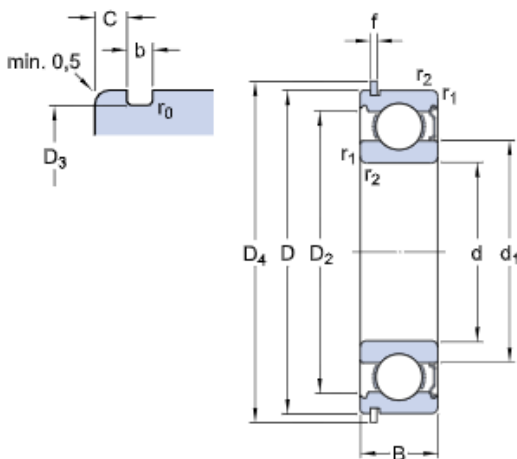

DIMENSIONS

d	70 mm	Bore diameter
D	150 mm	Outside diameter
B	35 mm	Width
d_1	≈ 94.95 mm	Shoulder diameter
D_2	≈ 129.9 mm	Recess diameter
D_3	145.25 mm	Diameter of snap ring groove
D_4	159.7 mm	Outside diameter of snap ring
b	3.1 mm	Width of snap ring groove
C	4.9 mm	Distance outer ring from side face to snap ring groove
f	2.82 mm	Width of snap ring
r_0	max. 0.6 mm	Bottom radius of snap ring groove
$r_{1,2}$	min. 2.1 mm	Chamfer dimension

ABUTMENT DIMENSIONS

d_a	min. 82 mm	Diameter of shaft abutment
d_a	max. 94.9 mm	Diameter of shaft abutment
D_a	max. 138 mm	Diameter of housing abutment

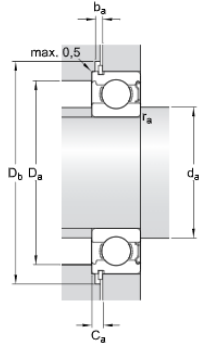

Db	min. 162 mm	Diameter of snap ring recess in the housing
ba	min. 3.5 mm	Width of snap ring recess in the housing
Ca	max. 7.72 mm	Distance from outer ring side face to snap ring back face
ra	max. 2 mm	Radius of shaft or housing fillet

CALCULATION DATA

C	111 kN	Basic dynamic load rating
C ₀	68 kN	Basic static load rating
P _u	2.75 kN	Fatigue load limit
	9 500 r/min	Reference speed
	6 300 r/min	Limiting speed
k _r	0.03	Minimum load factor
f ₀	13.2	Calculation factor

MASS

	2.66 kg	Mass bearing
--	---------	--------------

INCLUDED PRODUCTS

SP 150	Snap ring
--------	-----------

TOLERANCE CLASS

P6	Dimensional tolerances
Normal	Radial run-out